

**BOSE**®

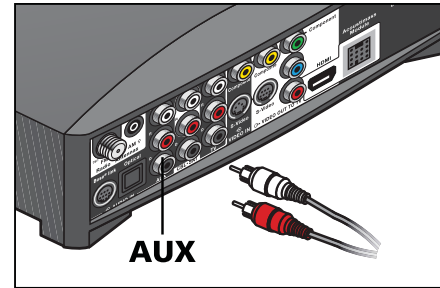
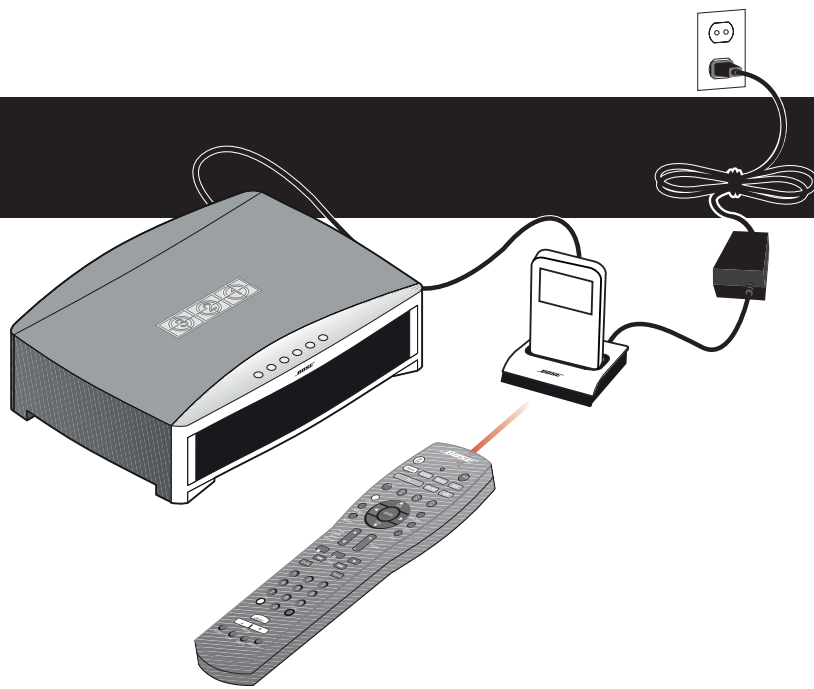

3·2·1® series III GS/GSX – page 32

**1**

7 sec.

AUX

**2**

ON

**3**

2 5 0 3

**4**

OFF

**5**

✓

The diagram illustrates a five-step process for pairing the remote control with the Bose receiver. Step 1: Press the AUX button for 7 seconds. Step 2: The red LED indicator turns ON. Step 3: Press the number keys 2, 5, 0, 3. Step 4: The red LED indicator turns OFF. Step 5: The system is ready, indicated by a green checkmark.

# BOSE®

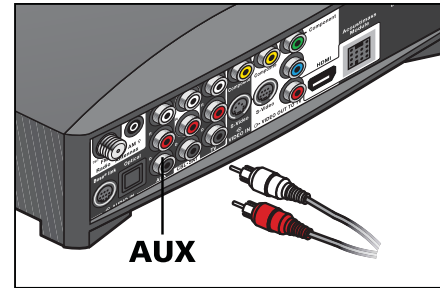
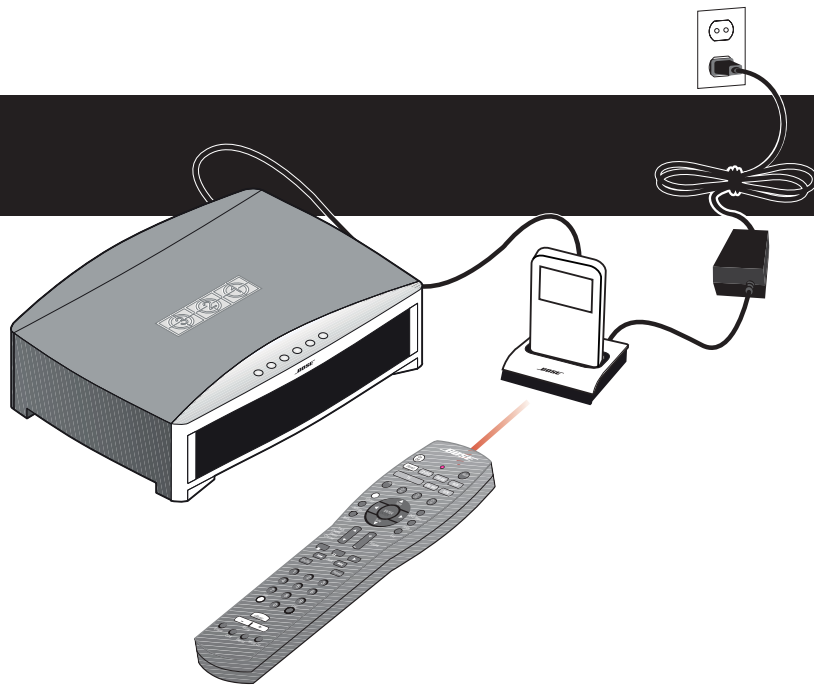

3·2·1® series III GS/GSX – page 32

**1**

7 sec.

**2**

**3**

2 5 0 3

**4**

**5**

A series of five numbered steps showing the remote control's display and button presses. Step 1: Pressing the AUX button. Step 2: A red dot on the display. Step 3: Pressing the number buttons 2, 5, 0, 3. Step 4: A white circle on the display. Step 5: The remote's display showing a green checkmark.